

**↗ DOMETIC**

# **AIR CONDITIONER**

# **FRESHWELL**



## **FreshWell FWX4350EHP**

<b>EN</b>	<b>Under-bench air conditioner</b>	
	Installation and Operating Manual.....	14

## Copyright

© 2025 Dometic Group. The visual appearance of the contents of this manual is protected by copyright and design law. The underlying technical design and the products contained herein may be protected by design, patent or pending patent. The trademarks mentioned in this manual belong to Dometic Sweden AB. All rights are reserved.

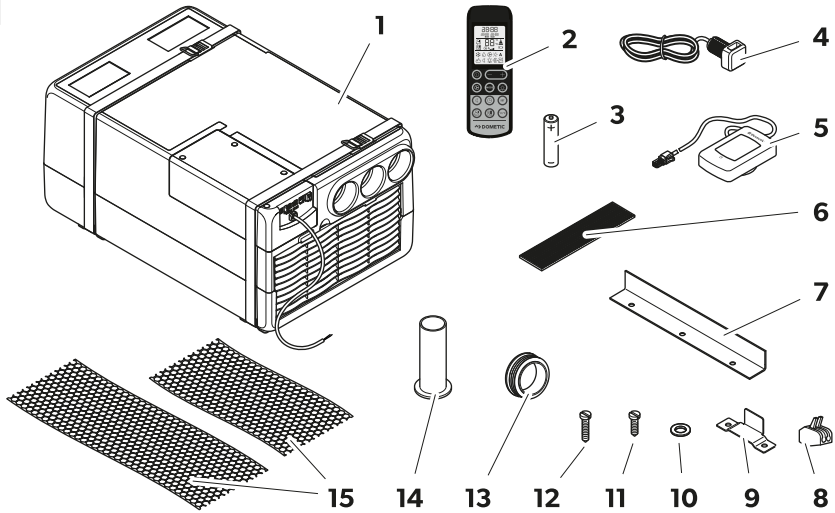
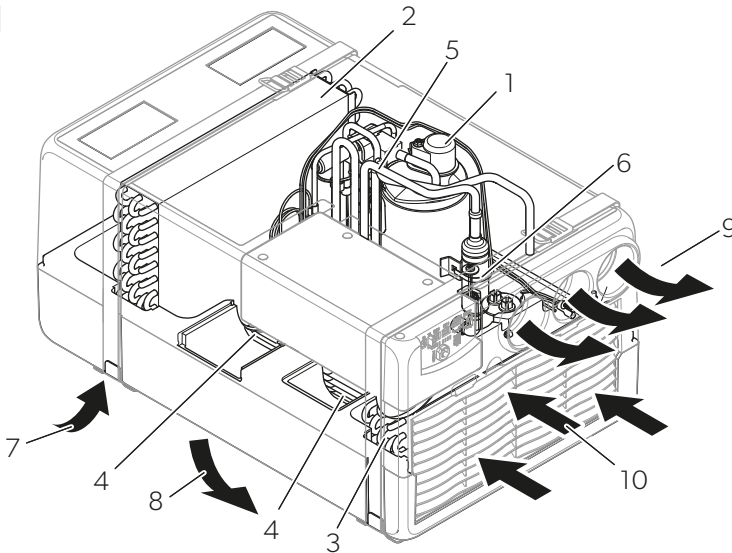
**1****2**

3

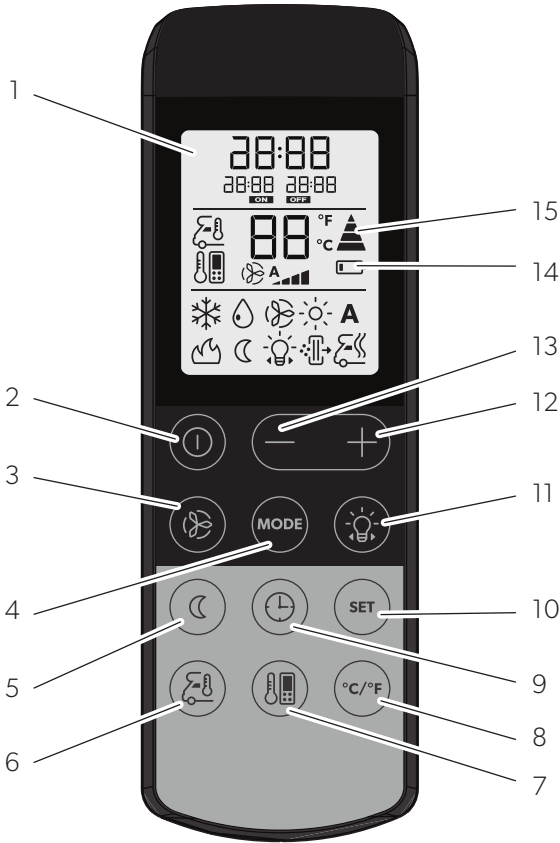

4

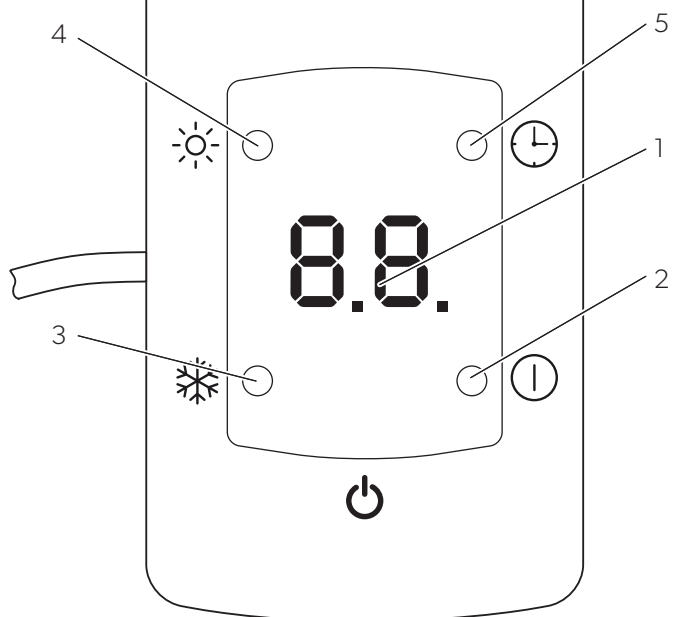

5 A

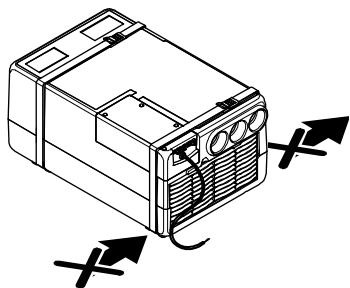

B

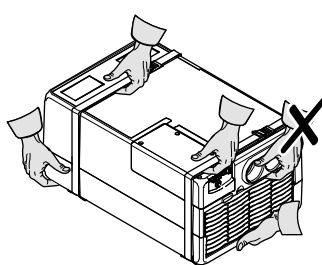



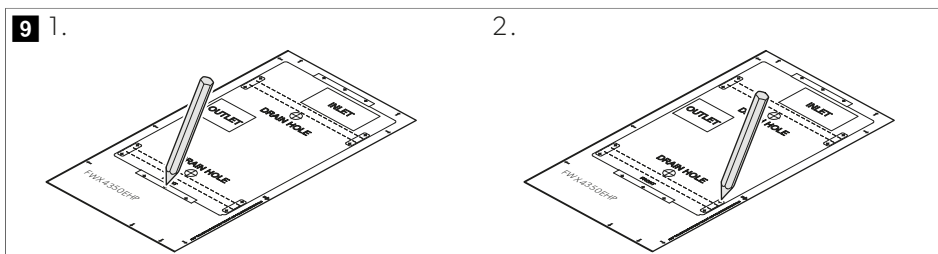
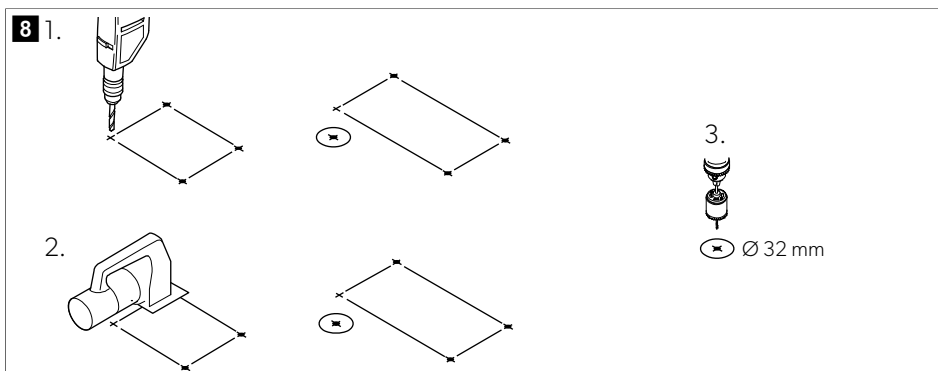
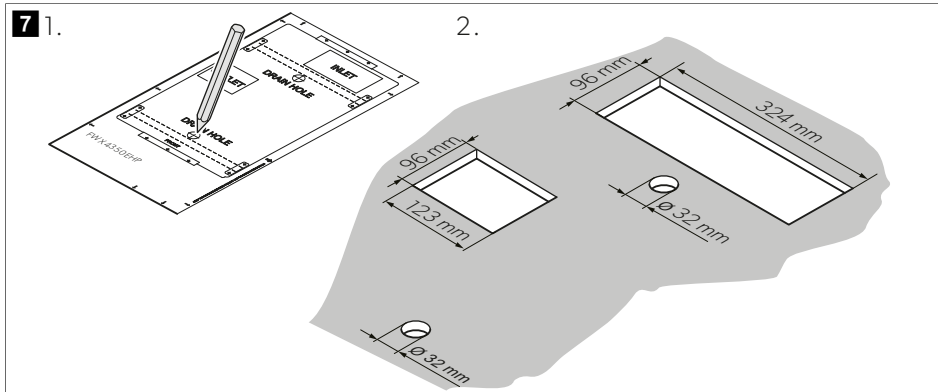

**10**

1.

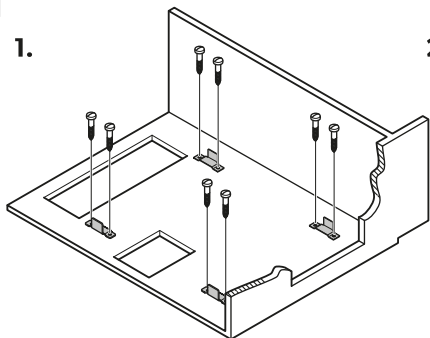

2.

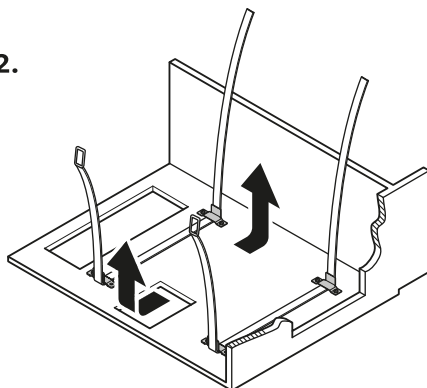

3.

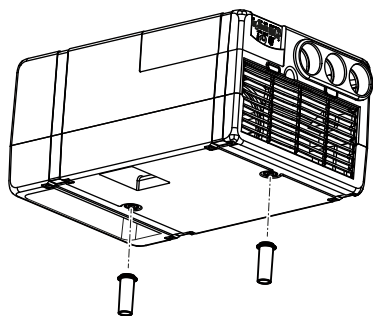

4.

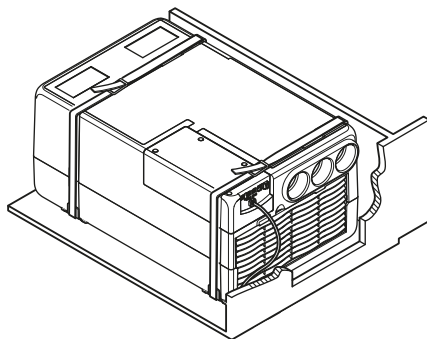
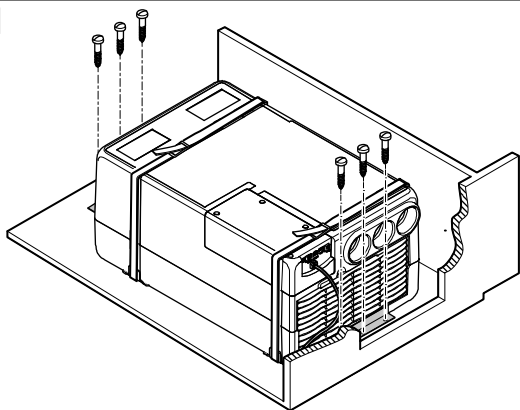
**11**

12

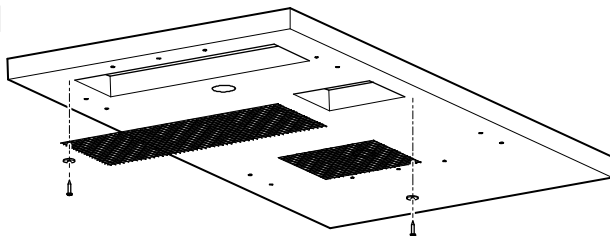

13

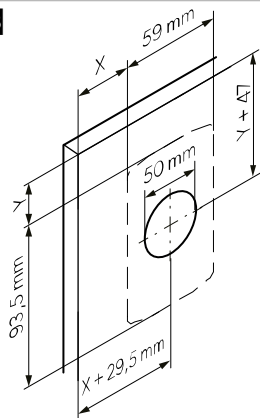

14

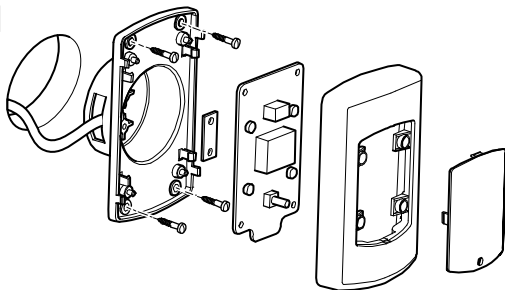

15

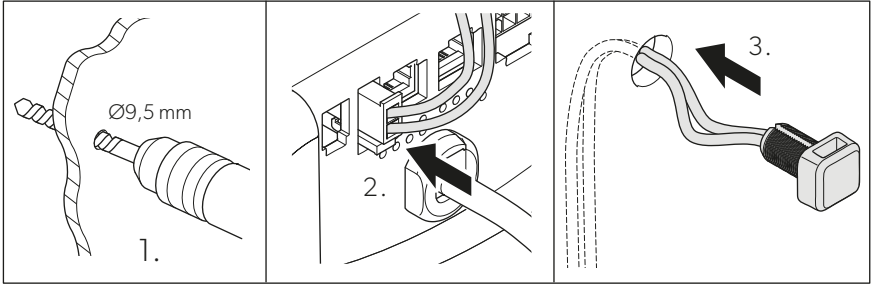

16

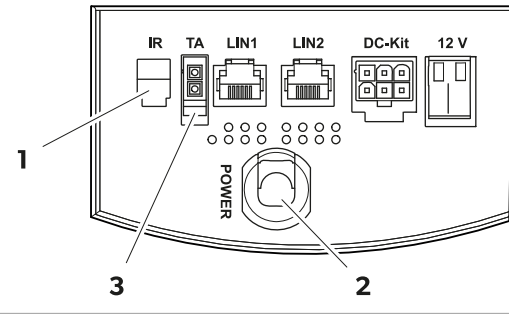

17

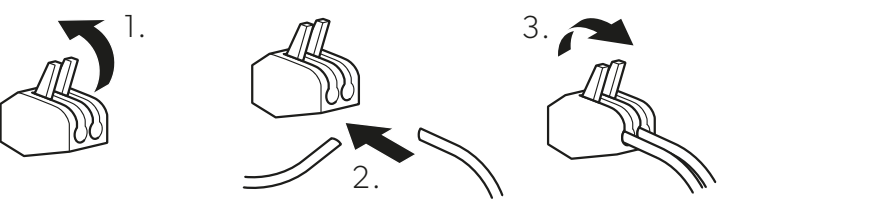

18

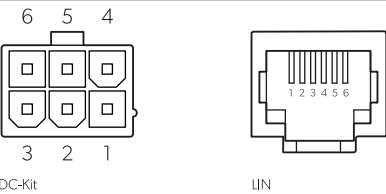

19

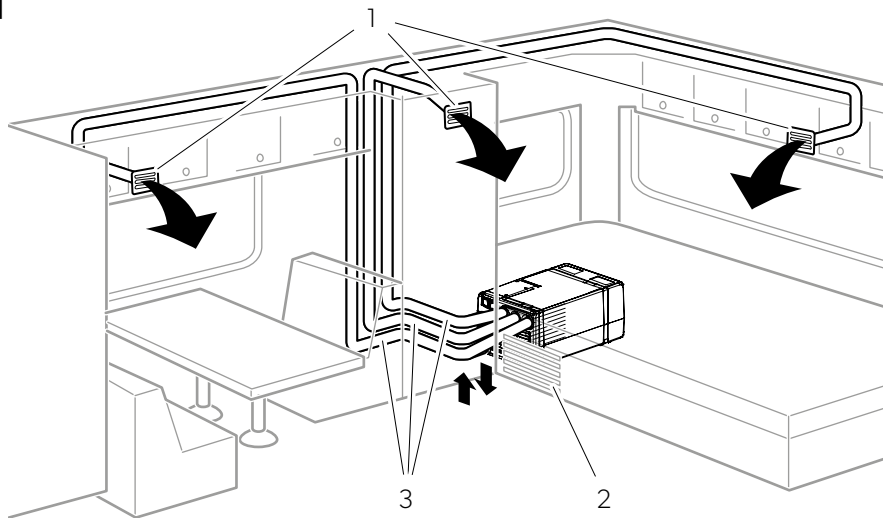

20

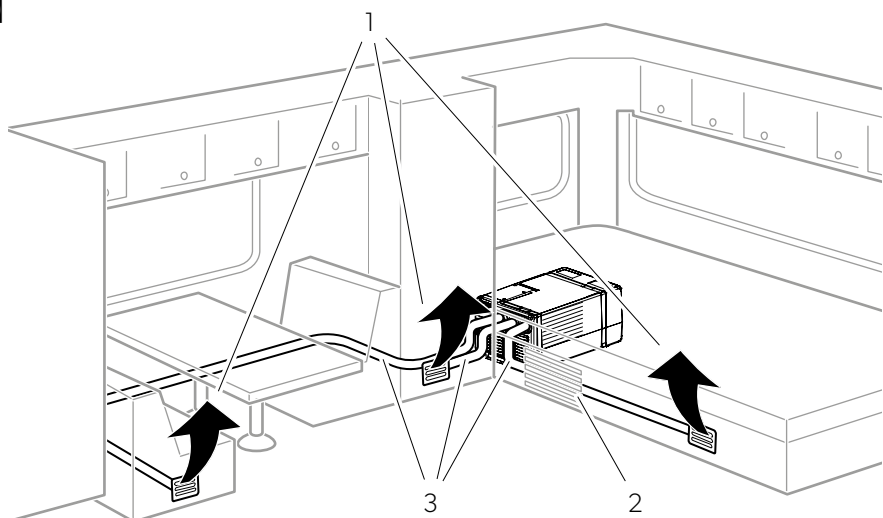

21

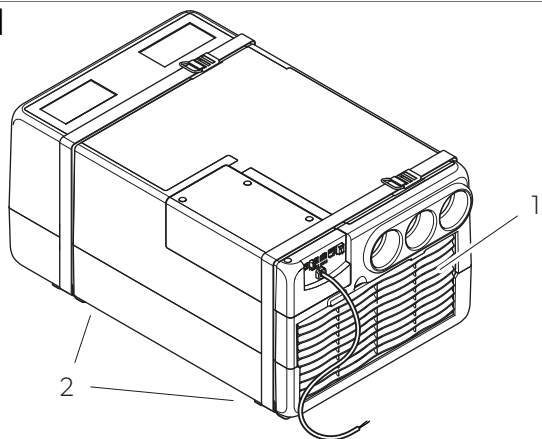

22

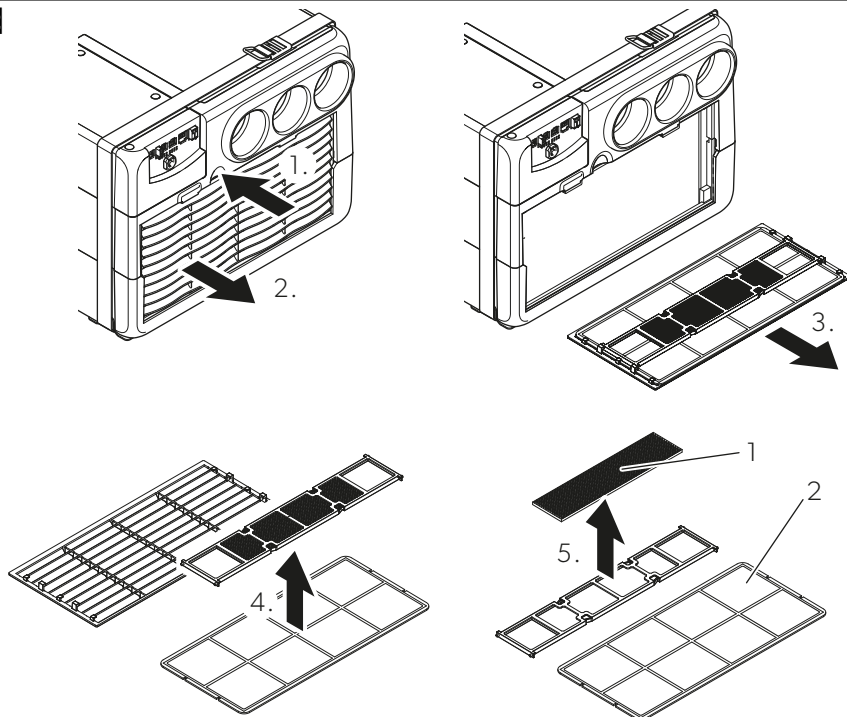

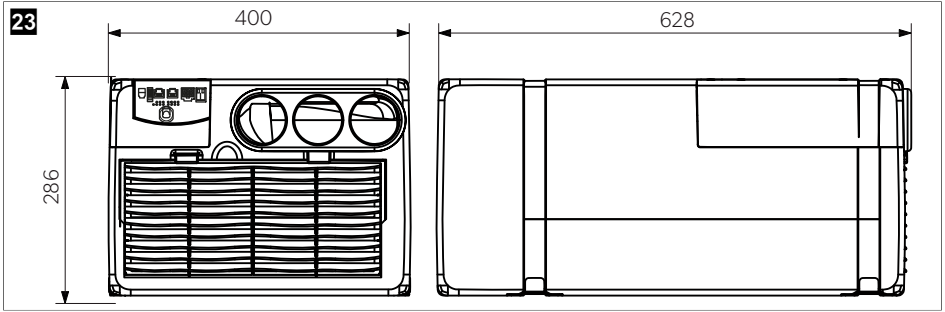

## English

1	Important notes.....	14
2	Cyber security.....	14
3	Explanation of symbols.....	14
4	Explanation of symbols on the device.....	15
5	Safety instructions.....	15
6	Target group.....	17
7	Scope of delivery.....	17
8	Accessories.....	17
9	Intended use.....	18
10	Technical description.....	18
11	Installation.....	22
12	Before first use.....	27
13	Operation.....	27
14	Cleaning and maintenance.....	31
15	Troubleshooting.....	32
16	Warranty.....	35
17	Disposal.....	35
18	Technical data.....	35

## 1 Important notes

Please read these instructions carefully and follow all instructions, guidelines, and warnings included in this product manual in order to ensure that you install, use, and maintain the product properly at all times. These instructions **MUST** stay with this product.

By using the product, you hereby confirm that you have read all instructions, guidelines, and warnings carefully and that you understand and agree to abide by the terms and conditions as set forth herein. You agree to use this product only for the intended purpose and application and in accordance with the instructions, guidelines, and warnings as set forth in this product manual as well as in accordance with all applicable laws and regulations. A failure to read and follow the instructions and warnings set forth herein may result in an injury to yourself and others, damage to your product or damage to other property in the vicinity. This product manual, including the instructions, guidelines, and warnings, and related documentation, may be subject to changes and updates. For up-to-date product information, please visit [documents.dometic.com](https://documents.dometic.com).

## 2 Cyber security

We confirm that this product complies with the Security and Telecommunications Infrastructure regulation (UK). The statement of compliance is available at [documents.dometic.com](https://documents.dometic.com). To report a security incident, email [productcybersecurity@dometic.com](mailto:productcybersecurity@dometic.com). Security updates will be provided for a minimum of five years after the manufacturing date.

## 3 Explanation of symbols

A signal word will identify safety messages and property damage messages, and also will indicate the degree or level of hazard seriousness.



### **WARNING!**

Indicates a hazardous situation that, if not avoided, could result in death or serious injury.



### **CAUTION!**

Indicates a hazardous situation that, if not avoided, could result in minor or moderate injury.



### **NOTICE!**

Indicates a situation that, if not avoided, could result in property damage.



**NOTE** Supplementary information for operating the product.

## 4 Explanation of symbols on the device



Warning! Low burning velocity material.



Read the operating manual.



Read the service manual.

## 5 Safety instructions

### General safety



#### **WARNING! Electrocutation hazard**

- > Installation, maintenance, and repairs of the device must only be carried out by qualified personnel who are familiar with the risks involved when handling refrigerant and air conditioning systems as well as the relevant regulations. For repair service contact the service center in your country (see [dometic.com/](http://dometic.com/) dealer).
- > If the device's power cable is damaged, the power cable must be replaced by the manufacturer, a service agent, or a similarly qualified person in order to prevent safety hazards.



#### **WARNING! Fire hazard**

- > Do not use the device near flammable fluids.
- > Ensure that no combustible objects are stored or installed near the air outlet. A distance of at least 50 cm must be kept.
- > Do not undo the upper cover of the device in the event of a fire. Use approved extinguishing agents instead. Do not use water to extinguish fires.
- > The refrigerant in the refrigerant circuit is highly flammable and in the event of a leakage combustible gases could build up if the device is in a small room. In the event of any damage to the refrigerant circuit: Keep open flames and potential ignition sources away from the device. Ventilate the room well. Switch off the device.
- > The appliance shall be stored in a room without continuously operating ignition sources such as open flames, an operating gas appliance or an operating electric heater.
- > Under no circumstances shall potential sources of ignition be used in the searching for or detection of refrigerant leaks. A halide torch (or any other detector using a naked flame) shall not be used.
- > Do not use means to accelerate the defrosting process or to clean, other than those recommended by the manufacturer.
- > Do not pierce or burn the appliance.
- > Be aware that refrigerants may not contain an odor.



### **WARNING! Risk of injury**

- > Do not operate the device if it is visibly damaged.
- > This device can be used by children aged from 8 years and above and persons with reduced physical, sensory or mental capabilities or lack of experience and knowledge if they have been given supervision or instruction concerning use of the device in a safe way and understand the hazards involved.
- > **Electrical devices are not toys.** Always keep and use the device out of the reach of very young children or infirm persons.
- > Children shall not play with the device.
- > Cleaning and user maintenance shall not be made by children without supervision.
- > Do not make any alterations or conversions to the device.
- > Do **not** reach into air outlets or insert any foreign objects in the underbench air conditioner.
- > Do not open or damage the refrigerant circuit under any circumstances.
- > Maintenance shall only be performed as recommended by the equipment manufacturer. Maintenance and repair requiring the assistance of other qualified personnel shall be carried out under the supervision of the person competent in the use of flammable refrigerants.



### **NOTICE! Damage hazard**

- > If faults occur in the device's refrigerant circuit, the device must be checked by a specialist company and properly repaired. The refrigerant must never be released into the air.
- > Do not apply heavy objects or pressure on the device.
- > Do not expose the under-bench air conditioner to water.

## **Installing the device safely**



### **WARNING! Risk of injury**

- > The device must be installed securely so that it cannot fall down.
- > Attach and lay the cables so that they cannot be tripped over or damaged.



### **NOTICE! Damage hazard**

- > Ensure that the voltage specification on the data plate is the same as the voltage specification of the power supply.
- > Use cable ducts to lay cables through walls with sharp edges.
- > Do not lay loose or bent cables next to electrically conductive materials.
- > Do not pull on the cables.

## **Operating the device safely**



### **WARNING! Electrocuting hazard**

Always disconnect the power supply when working on the device.



### **CAUTION! Risk of injury**

Do not touch the device during operation. The device contains hot and cold components, moving parts, and electrical items which may cause injury.



### NOTICE! Damage hazard

Avoid strong vibrations. The device will not work properly if it is exposed to strong vibrations.

## 6 Target group



The mechanical and electrical installation and setup of the device must be performed by a qualified technician who has demonstrated skill and knowledge related to the construction and operation of automotive and household equipment and installations, and who is familiar with the applicable regulations of the country in which the equipment is to be installed and/or used, and has received safety training to identify and avoid the hazards involved.

## 7 Scope of delivery

 **Fig. 1** on page 3

No.	Quantity	Description
1	1	Under-bench air conditioner
2	1	Remote control
3	2	Battery type AAA
4	1	Temperature sensor
5	1	Receiver
6	1	Carbon filter inlay
7	2	Mounting brackets
8	3	Fast connector
9	4	Fastening bracket
10	10	Washer
11	26	Screw 4 x 20 mm
12	4	Screw 3 x 15 mm
13	1	Air output cover
14	2	Drain pipe
15	2	External grids
-	1	Assembly template

## 8 Accessories

Description	Ref. no.
Air distribution pipe	9100300019
Air outlet grill	9100300077
90° bend	9100300015
Air intake grill	9100300017

Description	Ref. no.
DC KIT DSP-T 12	9600007286
DC KIT DSP-T 24	9600007287

## 9 Intended use

The under-bench air conditioner is intended to be installed in motor homes, caravans, and other vehicles with habitation compartments.

The under-bench air conditioner is **not** suitable for installation in:

- Houses and apartments
- Trucks and passenger vehicles
- Construction machinery, agricultural machinery, or similar equipment
- Boats and cruise liners
- Trains and airplanes

This product is only suitable for the intended purpose and application in accordance with these instructions.

This manual provides information that is necessary for proper installation and/or operation of the product. Poor installation and/or improper operation or maintenance will result in unsatisfactory performance and a possible failure.

The manufacturer accepts no liability for any injury or damage to the product resulting from:

- Incorrect installation, assembly or connection, including excess voltage
- Incorrect maintenance or use of spare parts other than original spare parts provided by the manufacturer
- Alterations to the product without express permission from the manufacturer
- Use for purposes other than those described in this manual

Dometic reserves the right to change product appearance and product specifications.

## 10 Technical description

The under-bench air conditioner supplies the interior of a vehicle with cool dehumidified air.

The under-bench air conditioner is operated with a remote control.

The under-bench air conditioner can lower the temperature within the vehicle to a certain level. The temperature depends on the type of vehicle, the ambient temperature, and the cooling capacity of the under-bench air conditioner.

The under-bench air conditioner is equipped with a defrost and a cold air prevention function. The defrost function prevents the external heat exchanger from icing up in the heating mode. The cold air prevention function prevents cold air from being blown into the vehicle while in heating mode.

### Components

The refrigerant circuit of the under-bench air conditioner consists of the following main components:

 **Fig. 2** on page 3

- **Compressor (1)**

The compressor draws in the refrigerant used and compresses it. This raises the pressure and the temperature of the refrigerant.

- **Condenser (2)**

The condenser ensures that the air flowing past absorbs the heat and the hot refrigerant gas cools down and becomes liquid.

- **Evaporator (3)**

The evaporators cool down and dehumidify the air flowing past them. The refrigerant absorbs the heat and vaporises.

- **Blower (4)**

The blower distributes the cooled or heated air within the vehicle through an air outlet unit.

- **4-way valve (5)**

The 4-way valve reverses the cooling circuit. Thus the internal register of the evaporator becomes a condenser and heats the air passing through.

- **Electric heating element (6)**

The electric heating element increases the heating effect when the outer temperature is low.

- **Air inlet (7), air outlet (8) for external heat exchanger**

Air is drawn into the under-bench air conditioner through the air inlet and escapes through the air outlet.

- **Register output (9), air inlet (10) for internal heat exchanger**









Air is drawn into the under-bench air conditioner through the air inlet and escapes through the register output. Depending on the operating mode, the internal heat exchanger heats or cools the air.



### Remote control

The settings of the under-bench air conditioner are performed via remote control.

The remote control is equipped with the following control and display elements:



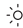



 **Fig. 3** on page 4

No.	Component	Description
1	Display	Displays the following: <ul style="list-style-type: none"> <li>• Time</li> <li>• Selected room temperature in °C or °F</li> <li>• Actual room temperature</li> <li>• Air conditioning mode</li> <li>• Blower level</li> <li>• Symbols for active additional functions</li> <li>• Battery status</li> </ul>
2	 button	Switches the air conditioner and remote control on or to standby mode.
3	 button	Selects the blower setting.
4	<b>MODE</b> button	Selects the air conditioning mode.
5	 button	Activates the sleep function.
6	 button	
	Press once:	Displays the current interior temperature (symbol  is displayed).
	Press again:	Displays the set temperature.
7	 button	No function assigned yet.
8	<b>°C/°F</b> button	Switches between the Celsius (°C) and Fahrenheit (°F) temperature units .
9	 button	Sets the timer and the clock.
10	<b>SET</b> button	Confirms and saves settings.
11	 button	No function.

No.	Component	Description
12	+ button	Increases the selected value.
13	- button	Reduces the selected value.
14	 symbol	Is displayed when the batteries in the remote control are empty.
15	 symbol	Is displayed when the remote control is transmitting values to the underbench air conditioner.

### Air conditioning modes

The under-bench air conditioner has the following air conditioning modes:

Air conditioning mode	Display message	Description
Automatic	<b>A</b>	The under-bench air conditioner regulates the interior temperature to the set temperature by heating or cooling and controlling the required blower speed. <b>Note:</b> In "Automatic" mode the  button, the + and - buttons are deactivated.
Cooling		The under-bench air conditioner cools the interior temperature to the set temperature with the configured blower settings.
Heating		The under-bench air conditioner heats the interior temperature to the set temperature with the configured blower settings.
Circulating air		The blower operates to circulate air without heating or cooling with the configured blower settings.
Dehumidification		The under-bench air conditioner regulates the interior temperature to the set temperature by cooling and controlling the required blower speed. In addition, the under-bench air conditioner removes moisture from the air. <b>Note:</b> In the "Dehumidification" mode the  button is deactivated.
Sleep		<b>In cooling mode:</b> When the room temperature is 2°C higher than the set temperature, the compressor starts to operate. When the room temperature falls 2°C below the set temperature, the compressor stops operating. <b>In heating mode:</b> When the room temperature is 2°C lower than the set temperature, the compressor starts to operate. When the room temperature increases 2°C above the set temperature, the compressor stops operating.



### Current air temperature in automatic mode

Current room temperature $\vartheta$	$\vartheta \leq 20^{\circ}\text{C}$	$22^{\circ}\text{C} < \vartheta < 25^{\circ}\text{C}$	$\vartheta \geq 25^{\circ}\text{C}$
Set point	20°C	22°C	25°C

Current room temperature $\vartheta$	$\vartheta \leq 20^{\circ}\text{C}$	$22^{\circ}\text{C} < \vartheta < 25^{\circ}\text{C}$	$\vartheta \geq 25^{\circ}\text{C}$
Air conditioning mode	"Heating" or "Circulating air"	"Dehumidification" or "Circulating air"	"Cooling"

### Timer function

The under-bench air conditioner is equipped with a timer function.

Display message	Description
	The air conditioner is switched on at the specified time.
	The air conditioner is switched off at the specified time.
	The air conditioner is switched on and off at the specified times.

### Receiver

The receiver has the following control and display elements:

 **Fig. 4** on page 5

No.	Component	State	Description
1	Display	On	The set temperature or the room temperature is displayed.
		Off	The receiver is switched off or in standby.
2	Red/green LED	Constantly red light	The standby mode is activated.
		Constantly green light	Any mode, except standby mode, is activated.
		Flashing red and green	The under-bench air conditioner is switched on. No supply voltage is present.
3	Blue LED	Constantly light	The "Cooling" mode is activated.
		Flashing	The "Dehumidification" mode is activated.
		Off	Any mode, except cooling and "Dehumidification" mode, is activated.
4	Orange LED	Constantly light	The "Heating" mode is activated.
		Flashing	The "Heating" mode is activated. The defrost function or the preventing cold air function is activated. The under-bench air conditioner is not producing hot air.
		Off	Any mode, except the "Heating" mode, is activated.
5	Yellow LED	Constantly light	The timer function is activated.
		Off	The timer function is deactivated.

## 11 Installation

### Note on installation

The following instructions must be observed while installing the under-bench air conditioner:



#### **DANGER! Electrocutation hazard**

Disconnect all power supplies when working on the under-bench air conditioner.



#### **CAUTION! Risk of injury**

- > Improper installation of the under-bench air conditioner can put the safety of the user at risk and result in irreparable damage to the device.
- > The manufacturer assumes no liability for malfunctions and for the safety of the under-bench air conditioner, especially for injury and/or damage to property, if the under-bench air conditioner is not fitted in accordance with these installation instructions.
- > Wear the recommended protective clothing (e. g., protective goggles, gloves) when installing the under-bench air conditioner.



#### **NOTICE! Damage hazard**

- > When installing the under-bench air conditioner observe the static of the vehicle and the sealing of all openings.
- > Ensure that no electrical cables or other parts of the vehicle can be damaged before drilling any holes.

### Transporting the under-bench air conditioner





#### **CAUTION! Risk of injury**

Do not carry the under-bench air conditioner alone.



#### **NOTICE! Damage hazard**

- > Do not pull or push the under-bench air conditioner (  Fig. 5, A).
- > Do not use the ventilation slots to lift the under-bench air conditioner (  Fig. 5, B).

#### Fig. 5 on page 5

### Installation location

- To install the device it is necessary to create openings in the floor. Ensure that the openings are accessible and not covered by any parts of the vehicle.
- Before installing the underbench air conditioner, ensure that no vehicle parts can be damaged by the installation of the under-bench air conditioner (e. g., wirings, lamps, cabinets, doors).
- The inclination of the installation surface must not exceed 10°.
- Install the under-bench air conditioner in a central location of the vehicle (e. g., in a compartment or similar housing) to achieve optimal air conditioning of the vehicle.
- Choose a location that is easily accessible for maintenance, disassembly, and installation.
- The under-bench air conditioner must be installed on the floor.
- Before drilling holes place the mounting template in the selected compartment to check the available space for the holes on the floor.
- Ensure that the under-bench air conditioner has a minimum distance of 30 mm from walls and furniture all around to minimize the transmission of noise and vibrations during operation.
- Keep a distance of 20 cm between the front of the under-bench air conditioner and the walls of the compartment to facilitate filter replacement.

- When installing the under-bench air conditioner in an external compartment (e. g., false floor), the air to be treated must be drawn from the passenger compartment of the vehicle.
- Ensure that no outside air is drawn in. The intake of outside air can significantly reduce the efficiency of the under-bench air conditioner.

### Notes on the electrical system

 **Fig. 6** on page 6

Item	Description
1	Main board
2	Condensation sensor
3	Motor protector
4	Temperature limiter
5	Heater element
6	Thermal connection
7	Heater relay
8	Reversing valve
9	Power
10	Evaporator sensor
11	Interface board
12	Room temperature sensor
13	Display board
14	Start capacitor
15	Soft start
16	Operating capacitor
17	Condensation fan
18	Evaporator fan
bu	Blue
bn	Brown
ye	Yellow
gn	Green
rd	Red
bk	Black
vt	Violet

- Ensure that the voltage specification on the type plate is the same as that of the power supply.
- Install an all-pole switch with a contact opening width of at least 3 mm on the installation side.

- If the under-bench air conditioner is powered by the mains, install a 2-pole switch that interrupts the AC voltage supply in case of overcurrent.
- If the under-bench air conditioner is powered by the mains, ensure that the AC voltage supply has a residual current circuit breaker.
- Ensure that the grounding cable of the under-bench air conditioner is connected to the vehicle's grounding system.

### Making openings

1. Mark the position and size of the openings using the template.

 **Fig. 7 on page 7**

2. Drill out the corners.

 **Fig. 8 on page 7**

3. Cut out the openings using a keyhole saw or a similar tool.

4. Drill out a condensation water drainage opening with a diameter of 32 mm.

5. Mark the position of the mounting brackets ( **Fig. 9, 1**) and the fastening brackets ( **Fig. 9, 2**).

 **Fig. 9 on page 7**

### Installing the fastening brackets and belts

 **Fig. 10 on page 8**

1. Fasten the fastening brackets ( **Fig. 10, 1**).

2. Pull the belts through the fastening brackets ( **Fig. 10, 2**).

3. Install the drain pipes underneath the under-bench air conditioner ( **Fig. 10, 3**).

4. Fasten the under-bench air conditioner with the belts ( **Fig. 10, 4**).

### Installing the mounting brackets

- > Fasten the under-bench air conditioner with the 2 angle profiles. Use 3 screws for each mounting bracket to fix it.

 **Fig. 11 on page 8**

### Installing the external grids

- > Fasten the external grids with screws and washers.

 **Fig. 12 on page 9**

### Installing the receiver (optional)

1. Drill an opening of 50 mm into the wall.

 **Fig. 13 on page 9**

2. Lay the cable through the hole to the under-bench air conditioner.

3. Fasten the receiver.

 **Fig. 14 on page 9**

### Installing a control panel (optional)

The under-bench air conditioner can be connected and controlled with the CI bus of the vehicle instead of the remote control including the receiver.

- > If desired, connect the under-bench air conditioner to the CI bus of the vehicle.



**NOTE** Follow the manufacturer's instructions.

### Installing the temperature sensor

When installing the temperature sensor note the following:

- Install the temperature sensor in chest height.
  - Install the temperature sensor on the opposite side of the air outlets in the vehicle.
  - Incorrect installation of the temperature sensor may cause malfunction of the under-bench air conditioner and poor air distribution. If the installation of the temperature sensor is incorrect, the under-bench air conditioner will run continuously or stop working without reaching the target temperature.
1. Drill a hole into the wall in front of the under-bench air conditioner.



**NOTE** Ensure that the hole is drilled so that the temperature sensor is not placed outside the vehicle.

**Fig. 15 on page 10**

2. Plug the temperature sensor into the "TA" connector ( Fig. 16, 3) of the under-bench air conditioner.
3. Insert the sensor through the drilled hole.
4. Put the plastic cover on the temperature sensor.

### Laying the connecting cables



#### **DANGER! Electrocutation hazard**

Ensure that no voltage is applied to electrically operated components before carrying out any work on them.

1. Select the cross-section of the cable corresponding to the length:
  - Length < 7.5 m: 1.5 mm<sup>2</sup>
  - Length > 7.5 m: 2.5 mm<sup>2</sup>
2. Plug the 4-pole plug of the receiver into the IR socket of the air conditioner ( Fig. 16, 1).

**Fig. 16 on page 10**

3. Connect the 230 V ~ cable ( Fig. 16, 2) to a power supply using the fast connectors.

**Fig. 17 on page 10**

4. **Optional:** Connect the DC-Kit (Accessories on page 17) and/or LIN bus of the vehicle to the under-bench air conditioner.

Follow the manufacturer's instructions.

**Fig. 18 on page 10**

**Table 1: Legend**

	DC-Kit	LIN
Pin	Description	
1	Ground	Ground

Pin	DC-Kit	LIN
	Description	
2	Ground	Ground
3	Ground	Ground
4	Economy	Ground
5	Remote On	NC
6	Inverter	Ground

## Installing the air ducting



**NOTE** Do not use short-cuts when installing inlets and outlets under the vehicle. Otherwise the under-bench air conditioner will draw the discharged air back in. The drawn-in air circulates in the under-bench air conditioner and affects the efficiency and the distribution of the air in the vehicle.

Placement of the air ducting for efficient cooling:

**Fig. 19 on page 11**

Placement of the air ducting for efficient heating:

**Fig. 20 on page 11**

1. Install air ducting ( Fig. 19/ Fig. 20,1) and ventilation pipes ( Fig. 19/ Fig. 20,3).



### NOTE

- When installing the air ducting, take into account that the air ducts can be optimally placed only for cooling or heating, and not for both at the same time.
- It is recommended to use cardboard pipe for air conditioning with an aluminium core and external covering of PVC. The nominal inside diameter should be 60 mm. The outside diameter should size up to 65 mm.

Follow the manufacturer's instructions.

2. Ensure that the ventilation pipes ( Fig. 19/ Fig. 20,3) are connected by pressing them together using the conical hole on the air outlet.
3. Ensure that the pipes are connected to the register output (Components on page 18, 10).
4. To achieve the best efficiency follow these instructions:
  - a) Lay the air pipes as short and straight as possible.
  - b) Restrict the length of the pipes to 5 m.
  - c) Do not lay the pipes near heat sources.
5. Create the recirculation air opening ( Fig. 19/ Fig. 20,2) near the under-bench air conditioner.



**NOTE** The recirculation air openings or grille must have a total cross section of at least 300 cm<sup>2</sup> to draw in sufficient recirculation air.

If the installation of the recirculation air opening ( Fig. 19/ Fig. 20,2) near the under-bench air conditioner is not possible, ensure that the air flow is not obstructed by other objects. If necessary, create an air duct between the openings and the under-bench air conditioner.

6. To avoid condensation on the pipes insulate the pipes with insulation material.

## 12 Before first use



### NOTE

Ensure that both the air intake opening and the air nozzles are free. All ventilation grilles must always be kept free to ensure that the under-bench air conditioner is able to operate at maximum capacity.

### Setting the remote control

1. Insert the batteries (see Replacing the remote control batteries on page 31).
  - ✓ The display shows all symbols for 5 s.
2. Press simultaneously the and buttons during this 5 s.
  - ✓ The display shows the default model number.
3. Press simultaneously **+** and **-** buttons within 3 s to select the model number:
  - FreshWell: **02**
  - FreshJet: **07**
  - FreshLight: **11**
  - ✓ The display shows all symbols for 5 s. Afterwards the remote control is ready for operation.

### Setting the time

- > Set the current time (see Setting the time on page 29).

## 13 Operation



### NOTICE! Damage hazard

Do not use the under-bench air conditioner if the vehicle is tilted more than 10°.



### NOTE

- Operate the under-bench by remote control or via LIN bus. When using a LIN bus control the receiver is not required.
- The remote control must be pointed at the IR sensor ( Fig. 4, 4) on the receiver during operation. The under-bench air conditioner confirms the receipt of data with a high note.

### Basic notes on operation

The under-bench air conditioner has 2 operating modes:

Operating modes	Features
Standby	The under-bench air conditioner is ready for operation and can be switched on with the remote control.
On	The under-bench air conditioner is conditioning the air in the interior.

The receiver switches on when it receives pulses from the remote control. The display shows (flashing) the temperature setting, after 20 s the display shows the room temperature, then it switches off.

Use the remote control for the following purposes:

- Switching the under-bench air conditioner to and from standby mode
- Adjusting the settings
- Selecting additional functions

## Hints for improved use

Observe the following hints to optimize the performance of the under-bench air conditioner:

- Improve the heat insulation of the vehicle by sealing gaps and hanging reflective blinds or curtains on your windows.
- If the vehicle has been exposed to direct sunlight for a long period of time and the ambient temperature in the vehicle is high, operate the under-bench air conditioner in the “Circulating air” (🌀) mode with the windows open for a few minutes before activating the “Cooling” (❄️) mode.
- Avoid opening doors and windows as far as possible when using the under-bench air conditioner.
- Select an appropriate temperature and blower speed.
- Align the air nozzles sensibly.
- Ensure that the air nozzles and intake grille are not covered.
- To improve the heating performance let the warm air flow as deep as possible into the interior by turning the outlets slightly downwards.
- To improve cooling performance allow the cold air to enter the passenger compartment as far up as possible by turning the outlets slightly upwards.
- Close all blinds.

## Switching the under-bench air conditioner on or to standby

> Press the ① button.

√ A signal tone sounds.

**Switched on:** After a few minutes the under-bench air conditioner starts condition the air to the values that were set most recently.

**Switched to standby:** The underbench air conditioner stops conditioning the air.

## Switching only the remote control to or from standby

If the remote control is not pointing to the IR sensor (📺 Fig. 4, 4) on the control panel, the remote control can be activated or switched to standby independently from the under-bench air conditioner.

> Press the ① button.

√ If the remote control is switched to standby, its display shows only the time.

If the remote control is activated, several symbols are shown on its display.

## Selecting the air conditioning mode





1. Ensure the under-bench air conditioner is switched **on**.
  2. Select the desired mode using the **MODE** button (see Air conditioning modes on page 20).
- √ A signal tone sounds. The under-bench air conditioner is switched to the selected mode.

## Selecting the blower speed manually

The blower controls the strength of the air supply.

In the “Cooling” (❄️), “Heating” (🔥) and “Circulating air” (🌀) modes the blower levels can be selected manually. In the other air conditioning modes the under-bench air conditioner controls the blower level automatically and the remote control displays only the blower level symbols without the corresponding code.

1. Ensure that the under-bench air conditioner is switched **on**.
2. Ensure that the “Cooling” (❄️), “Heating” (🔥) or “Circulating air” (🌀) mode is activated.
3. Use the 🌀 button to select the desired blower level.

Display message		Description
Symbol	Code	
	F1	Low blower level
	F2	Medium blower level
	F3	High blower level <b>Not</b> available in the “Cooling” (❄️) mode.
		Automatic blower mode, only available in the “Cooling” (❄️), “Heating” (🔥), and “Automatic” (A) modes.

- ✓ A signal tone sounds. The new blower level has been set.  
The blower level code disappears after a few seconds and the set temperature is displayed.

## Setting the temperature

### Cooling mode

In the “Cooling” (❄️) and “Dehumidification” (💧) modes a temperature between 16°C and 31°C can be set via the remote control.



1. Ensure that the under-bench air conditioner is switched **on**.
  2. Ensure that the “Cooling” (❄️) or “Dehumidification” (💧) mode is activated.
  3. Use the + or – button to select the desired temperature.
- ✓ A signal tone sounds. The temperature is set on the under-bench air conditioner.

### Heating mode

In the “Heating” (🔥) mode a temperature between 16°C and 31°C can be set via the remote control.

1. Ensure that the under-bench air conditioner is switched **on**.
  2. Ensure that the “Heating” (🔥) mode is activated.
  3. Use the + or – button to select the desired temperature.
- ✓ A signal tone sounds. Afterward the temperature is set on the under-bench air conditioner.

## Displaying the temperature

- > Press the  button once to displays, the current interior temperature.
- ✓ The  symbol and the current interior temperature of the remote control are displayed on the remote control display.
- > Press the  button twice to display the set temperature.

## Setting the time



The remote control needs the current time in order to program the timer. The time is indicated on the display of the remote control.





**NOTE** The remote control returns to its initial mode and saves the current setting if no button is pressed on the remote control for 15 s while setting the time.

Proceed as follows to set the time:

1. Ensure that the remote control is switched **on**.

2. Press and hold the  button for 2 s .
  - ✓ The time display flashes.
3. Use the  or  button to set the current time.



**NOTE** Press the  or  longer than 2 s to increase or decrease the time faster.

4. Press the **SET** button to confirm the set time setting.

### Setting the timer



The timer function allows to set a specific time period for air conditioning. The switch-on time, the switch-off time or both values can be specified.





**NOTE** The remote control returns to its initial mode if no button is pressed on the remote control for 15 s while programming the timer.

1. Ensure that the under-bench air conditioner is switched **on** (Switching the under-bench air conditioner on or to standby on page 28).
2. Select the air conditioning mode and all required values (e.g., temperature).
3. Set the desired timer:
  - Setting the switch-on time on page 30
  - Setting the switch-off time on page 30
  - Setting the switch-on and switch-off times on page 30

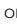

### Setting the switch-on time

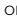

1. Switch the under-bench air conditioner to **standby** (Switching the under-bench air conditioner on or to standby on page 28).
2. Press the  button once.
  - ✓ The **ON** symbol () flashes on the display of the remote control.
3. Use the  or  button to set the time when the under-bench air conditioner shall switch on.
4. Press the **SET** button to transmit the value to the under-bench air conditioner.
  - ✓ The under-bench air conditioner is switched on with the selected air conditioning mode at the specified time.
5. Switch the under-bench air conditioner to standby (see Switching the under-bench air conditioner on or to standby on page 28).

### Setting the switch-off time

1. Press the  button twice.
  - ✓ The **OFF** symbol () flashes on the display of the remote control.
2. Use the  or  button to set the time when the under-bench air conditioner shall switch off.
3. Press the **SET** button to transmit the value to the under-bench air conditioner.
  - ✓ The under-bench air conditioner starts in the selected mode at the specified time and operates until the second specified time is reached.

### Setting the switch-on and switch-off times

1. Press the  button three times.
  - ✓ The **ON** symbol () flashes on the display of the remote control.
  - The **OFF** symbol () is displayed.

2. Use the **+** or **-** button to set the time when the under-bench air conditioner shall switch on.
3. Press the  button.
  - ✓ The **OFF** symbol () flashes on the display of the remote control.
4. Use the **+** or **-** button to set the time when the under-bench air conditioner shall switch off.
5. Press the **SET** button to transmit the value to the under-bench air conditioner.
  - ✓ The under-bench air conditioner starts in the selected mode at the specified time and operates until the second specified time is reached.
6. Switch the under-bench air conditioner to standby (see Switching the under-bench air conditioner on or to standby on page 28).

### Canceling timer setting

If the timer has been set, these settings can be canceled as follows:

- > Press the  button 5 times.
- ✓ The timer symbol disappears. The setting has been canceled.

### Activating and deactivating the sleep function

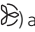
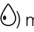

**NOTE** The sleep function is deactivated in "Circulating air" () and the "Dehumidification" () modes.

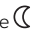
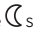
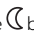
1. Ensure that the under-bench air conditioner is switched **on**.
2. Set the required temperature (see Setting the temperature on page 29).
3. Press the  button.
  - ✓ The  symbol appears in the remote control display. The sleep function is activated.
4. To deactivate the sleep function press the  button again.



**NOTE** The sleep function is deactivated if the **MODE** button is pressed.

### Replacing the remote control batteries

Replace the batteries when the  symbol is displayed on the remote control display.

The battery compartment is placed on the back of the remote control.

1. Push down the lid of the battery compartment and slide it open in the direction of the arrow.
2. Insert 2 new batteries (type AAA) into the remote control as indicated in the battery compartment.
3. Close the cover of the battery compartment.

## 14 Cleaning and maintenance





#### **WARNING! Risk of injury**

Any other maintenance work additional to that described here may only be carried out by qualified personnel who are familiar with the relevant regulations and the risks involved when handling refrigerant and air conditioning systems.



#### **NOTICE! Damage hazard**

- > Do not clean the under-bench air conditioner with a high-pressure cleaner.
- > Do not use sharp or hard objects or cleaning agents for cleaning the under-bench air conditioner.

- > Clean the under-bench air conditioner with water and a gentle cleaning agent.
  - > **Never** clean the under-bench air conditioner with petrol, diesel, or solvents.
- > Clean the housing of the under-bench air conditioner and the air outlet unit occasionally with a damp cloth.
  - > Regularly remove dirt from the ventilation grilles (  Fig. 21, 1) of the under-bench air conditioner.
    -  Fig. 21 on page 12
  - > If necessary, clean the remote control with a slightly damp cloth. Use a cleaning cloth for glasses to clean the display of the remote control.
  - > Clean or replace the carbon filter once per year (Cleaning or replacing the carbon filter on page 32).

### Cleaning the carbon filter inley





Regularly clean the carbon filter inley of the under-bench air conditioner:

#### Fig. 22 on page 12

1. Pull the carbon filter inley (1) out of the fastening.
2. Clean the carbon filter inley (1) with a detergent solution and let it dry.
3. Put the dry carbon filter inley (1) back in.

### Cleaning or replacing the carbon filter

Clean or replace the carbon filter once per year:

1. Pull the carbon filter inley (  Fig. 22, 1) out of the fastening.
2. Remove the carbon filter (  Fig. 22, 2).
3. If necessary, clean the carbon filter (  Fig. 22, 1) with a detergent solution or replace it.
4. Insert the new/dry and clean carbon filter (  Fig. 22, 1).

### Checking the water drainage

- > Check whether the condensation water drainage channels (  Fig. 21, 2) at the sides of the under-bench air conditioner are clear and the condensation water is able to escape.

### Maintaining the heat exchanger

- > Have the heat exchanger of the under-bench air conditioner maintained once per year by a specialist workshop.

## 15 Troubleshooting

Problem	Possible cause	Suggested remedy
No cooling	The "Cooling" (❄️) mode is not set.	> Activate the "Cooling" (❄️) mode (see Cooling mode on page 29).
	The ambient temperature is above 52°C.	The under-bench air conditioner is only designed for ambient temperatures of -5 ... 52°C.
	The temperature set is higher than the room temperature.	> Select a lower temperature (see Setting the temperature on page 29).
	The ambient temperature is below 16°C.	> Activate the "Circulating air" (🌀) mode.

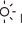
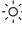
Problem	Possible cause	Suggested remedy
	<p>The thermal protection is defective.  The compressor is damaged.  The refrigerating agent filling is insufficient.  The heat exchange coils are polluted.  The external blower is defective.</p>	<ul style="list-style-type: none"> <li>&gt; Contact an authorized workshop.</li> </ul>
	<p>The freeze protection function is regularly active. The compressor switches on and off repeatedly without reaching the set temperature.</p>	<ul style="list-style-type: none"> <li>&gt; Select the highest fan speed (see <i>Selecting the blower speed manually</i> on page 28).</li> </ul>
	<p>The air inlet and/or the outlet openings under the vehicle are blocked.</p>	<ul style="list-style-type: none"> <li>&gt; Clean the air inlet and/or the outlet openings (see <i>Cleaning and maintenance</i> on page 31).</li> </ul>
	<p>The air inlets and outlets are installed too close to each other.</p>	<ul style="list-style-type: none"> <li>&gt; Turn the air outlets away from the air inlet.</li> </ul>
No heating	<p>The "Heating"  mode is not set.</p>	<ul style="list-style-type: none"> <li>&gt; Activate the "Heating"  mode (see <i>Heating mode</i> on page 29).</li> </ul>
	<p>The ambient temperature is below -5°C.</p>	<p>The under-bench air conditioner is only designed for ambient temperatures of -5 ... 52°C.</p>
	<p>The temperature set is lower than the room temperature.</p>	<ul style="list-style-type: none"> <li>&gt; Select a higher temperature (see <i>Setting the temperature</i> on page 29).</li> </ul>
	<p>The ambient temperature is higher than 31°C.</p>	<p>The temperature is only adjustable between 16 ... 31°C.</p>
	<p>The thermal protection is defective.  The compressor is damaged.  The refrigerating agent filling is insufficient.  The heat exchange coils are polluted.  The external blower is defective.</p>	<ul style="list-style-type: none"> <li>&gt; Contact an authorized service agent.</li> </ul>
	<p>The air inlet and/or the outlet openings under the vehicle are blocked.</p>	<ul style="list-style-type: none"> <li>&gt; Clean the air inlet and/or the outlet openings (see <i>Cleaning and maintenance</i> on page 31).</li> </ul>
The under-bench air conditioner generates a low air output.	<p>The air filter is obstructed.</p>	<ul style="list-style-type: none"> <li>&gt; Clean the air filter (see <i>Cleaning the carbon filter inley</i> on page 32).</li> </ul>

Problem	Possible cause	Suggested remedy
	The heat exchange coils are polluted. The internal blower is defective.	> Contact an authorized service agent.
Water enters the vehicle.	The condensation water drainage openings are clogged up.	> Clean the drainage openings for condensation water (see Checking the water drainage on page 32).
	The seals are damaged.	> Contact an authorized service agent.
The under-bench air conditioner does not switch on.	No supply voltage ( 230 V ~) is connected.	> Check the power supply.
	The voltage is too low (under 200 V ~). The voltage converter is defective. The defective thermal protection is defective.	> Contact an authorized service agent.
	The electrical fuse of the power supply is blown.	> Check the electrical fuse of the power supply (see Technical data on page 35).
The under-bench air conditioner stops working.	The air filter is obstructed.	> Clean the air filter (see Cleaning the carbon filter inley on page 32).
	The voltage is too low (under 200 V ~). The voltage converter is defective. The defective thermal protection is defective. The condenser fan is damaged. The heat exchange coils are polluted. The external blower is defective.	> Contact an authorized service agent.
The under-bench air conditioner does not switch off.	A temperature sensor is defective.	> Contact an authorized service agent.
The receiver showing the error code <b>E1</b> .	An error has occurred on the room temperature sensor.	1. Ensure the wires and plugs are not defective and properly inserted. 2. If necessary, contact an authorized service agent.
The receiver showing the error code <b>E2</b> .	An error has occurred on the temperature sensor of the interior heat exchanger.	> Contact an authorized service agent.
The receiver showing the error code <b>E3</b> .	An error has occurred on the temperature sensor of the outdoor heat exchanger.	> Contact an authorized service agent.

Problem	Possible cause	Suggested remedy
The reciver showing the error code <b>E4</b> .	An error has occurred during communication with the control card.	> Contact an authorized service agent.

## 16 Warranty

The statutory warranty period applies. If the product is defective, please contact the manufacturer's branch in your country (see [dometic.com/dealer](http://dometic.com/dealer)) or your retailer.

For repair and warranty processing, please include the following documents when you send in the device:

- A copy of the receipt with purchasing date
- A reason for the claim or description of the fault

Note that self-repair or nonprofessional repair can have safety consequences and might void the warranty.

## 17 Disposal



### WARNING! Fire hazard

- > The refrigerant is highly flammable. Do not open or damage the refrigerant circuit.
- > The insulation of the device contains an insulating gas (see data plate). Do not damage the insulation.



If you wish to finally dispose of the product, ask your local recycling center or specialist dealer for details about how to do this in accordance with the applicable disposal regulations. The product can be disposed free of charge.







If the product contains any non-replaceable batteries, rechargeable batteries, or light sources, you don't have to remove them before disposal.



Recycling packaging material: Place the packaging material in the appropriate recycling waste bins wherever possible.

## 18 Technical data

	FreshWell FWX4350EHP
Rated input voltage	220 ... 240 V~, 50 Hz
Current consumption	
Rated cooling current	4.8 A
Maximum cooling current	6.2 A
Rated heating current	4.5 A
Maximum heating current	5.1 A
Required fuse	Approx. 6 A
Operating temperature range	-5 ... 52°C
Noise emission	< 58 dB(A)
Refrigerant	R32
Refrigerant quantity	0.43 kg

	<b>FreshWell FWX4350EHP</b>
CO <sub>2</sub> equivalent	0.290 t
Global warming potential (GWP)	675
Additional heating element	500 W
Blower	3 blower levels 1 Automatic mode
Protection class	IP X5
Max. volume of space in the vehicle (with insulated walls)	30 m <sup>3</sup>
Dimensions (in mm)	 <b>Fig. 23</b> on page 13
Weight	approx. 21 kg
Inspection/certification	  

This product contains fluorinated greenhouse gases.

The cooling unit is hermetically sealed.





[dometic.com](https://dometic.com)

---

## **YOUR LOCAL DEALER**

[dometic.com/dealer](https://dometic.com/dealer)

## **YOUR LOCAL SUPPORT**

[dometic.com/contact](https://dometic.com/contact)

## **YOUR LOCAL SALES OFFICE**

[dometic.com/sales-offices](https://dometic.com/sales-offices)

---